

Tumbling Tower Block Pumpkins

(SUPPLIES CREATE ONE SMALL & ONE LARGE PUMPKIN)

Supplies included:

- 9 Large tumbling tower blocks
- 1 Large wood cube
- 9 Small tumbling tower blocks
- 1 Small wood cube
- 2 Pieces of wire
- Paint (orange & brown)
- Bottle of Gorilla wood glue
- 4 punched paper leaves
- Small dowel

Additional supplies needed:

- Paint brush
- Cup of water
- Hot glue gun & hot glue sticks
- Paper to protect work surface

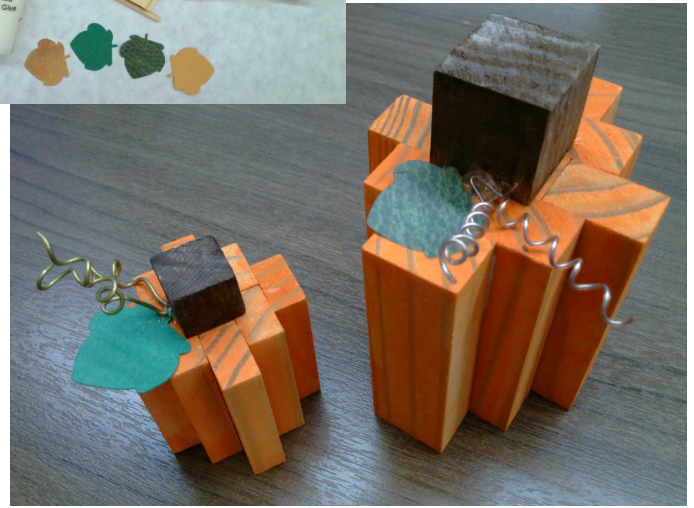
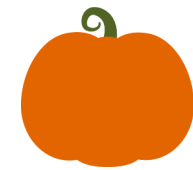

Step 1

Dip a paint brush in water then orange paint, thinning paint. Paint all tumbling tower blocks with thin coat of orange paint by dipping brush in water before painting so wood grain shows through paint. Rinse paint brush. Allow blocks to dry.

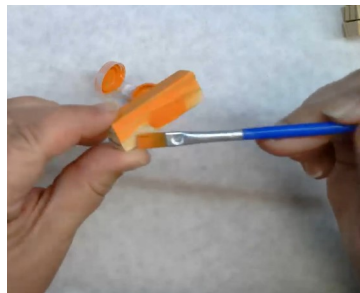

Step 2

Dip paint brush in water then brown paint, thinning paint. Paint both wood cubes brown. Rinse paint brush.

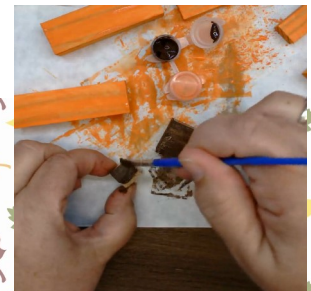

Step 3

Using Gorilla wood glue and a paint brush, attach three blocks lengthwise. Then glue two sets of two blocks lengthwise also.

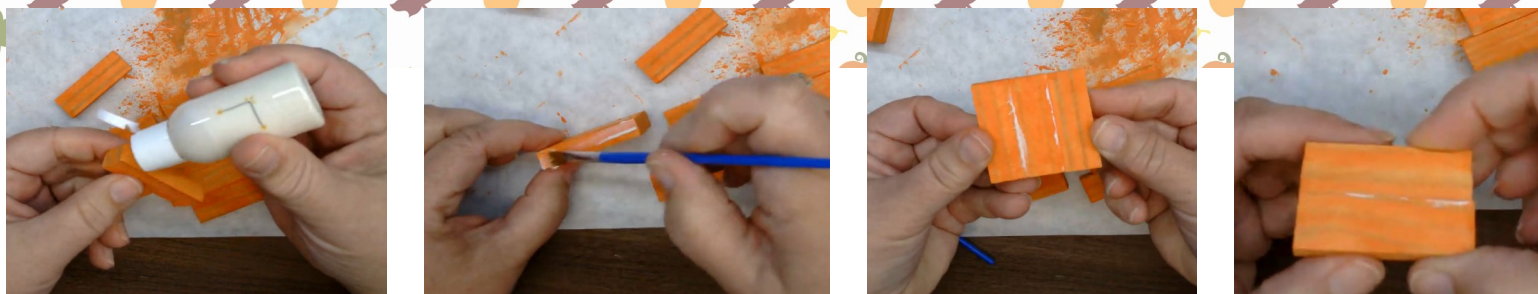

Step 4

Attach both sets of two blocks to set of three blocks, one set to each side.

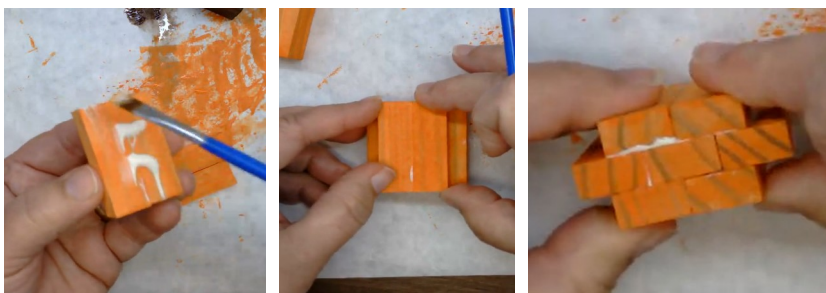

Step 5

Glue remaining two blocks to sets of two blocks, one to each side.

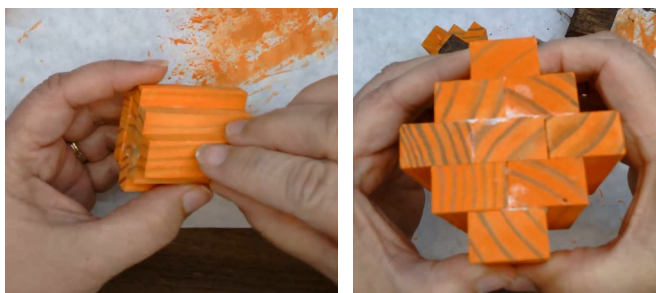

Step 6

Glue brown cube to orange blocks to make pumpkin stem.

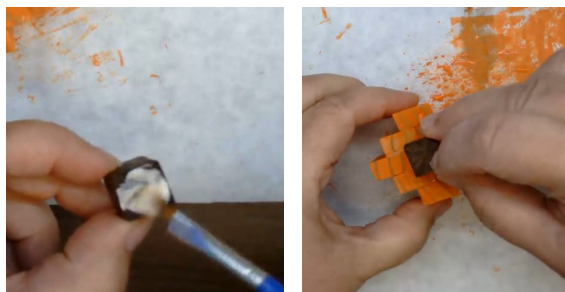

Step 7

Fold wire in half, wrap half around dowel, and slide wire off dowel. Repeat with other side and second wire.

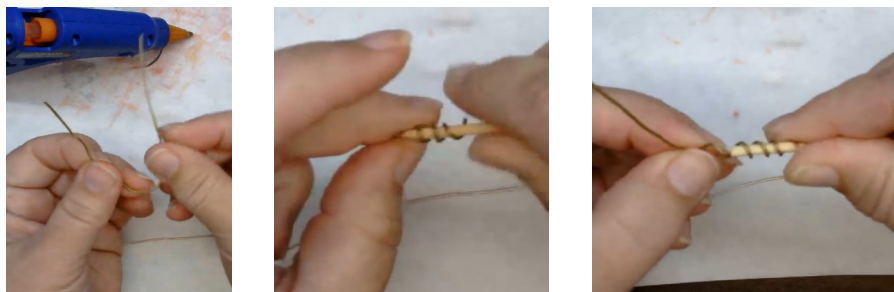

Step 8

Hot glue a leaf or two to each pumpkin. Hot glue a folded wire to each pumpkin.

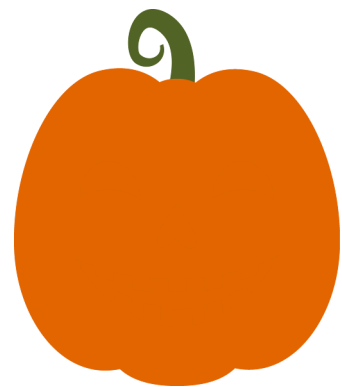
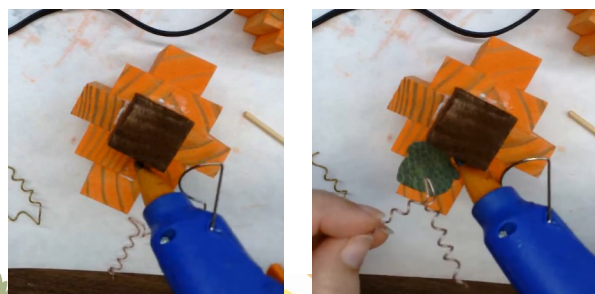

Craft instructions created by
Stephanie Coil,
Public Relations and Graphic Design
Way Public Library, Perrysburg, Ohio



Sponsored by our friends at
SKOTYNSKY
FINANCIAL GROUP, LLC